

结构优势与特点

Structural Advantages and Characteristics

1. 产品设计制造按ANSI B16.34 和E101标准的规定，结构合理，性能优良，造型美观。
 2. 阀门中腔采用压力自紧式密封结构，介质压力越高，密封性能越好。
 3. 支管两端为焊接结构，适应不同的接管要求。
 4. 阀瓣、阀座密封面采用司太立(stellite)钴基硬质合金焊而成，耐磨、耐高温、耐腐蚀、抗擦伤性能好、使用寿命长。
 5. 阀瓣绕转阀座外的销轴旋转，减少关闭时发生的猛烈冲击。
 6. 内装式的销轴结构，减小外泄漏点，使用更可靠。
1. Product design and manufacture according to the requirements of ANSI B16.34 and E101 standards, reasonable structure, performance Excellent, beautiful appearance.
 2. Valve cavity pressure self sealing structure, the higher the pressure, the better the sealing performance.
 3. Pipe ends welded structure, meet the requirements of different nozzle.
 4. The valve seat sealing surface with Stellite (Stellite) cobalt based alloy welding, wear resistance, High temperature resistance, corrosion resistance, scratch resistance, long service life.
 5. The valve flap rotates around the pin shaft outside the valve seat to reduce the impact of the closure. Pin
 6. Built-in type structure, reduce the leakage of leakage, the use of more reliable.

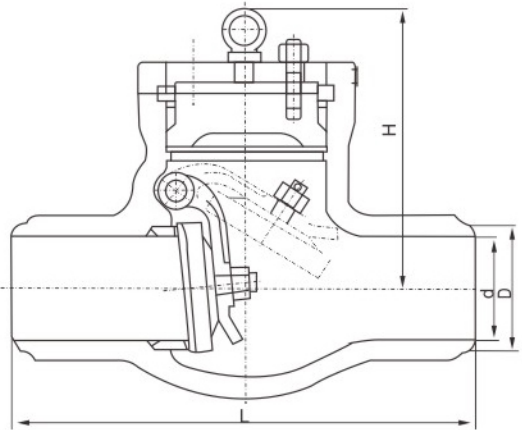

主要零件材质 Main Parts Material

零件名称 Part name	材料名称 Material name			
阀体 Body	WCB	WC1	WC6	WC9
阀座 Seat	25	15CrMo1V	12CrMo1V	
阀瓣 Valve	WCB	WC1	WC6	WC9
阀杆 Stem	WCB	WC1	WC6	WC9
阀盖 Valve cover	25	15CrMo1V	12Cr1MoVA	
销轴 Pin shaft	1Cr17Ni12		20Cr1MoVA	
密封环 Seal ring	S软钢或(增强柔性石墨) S (mild steel or flexible graphite)			

主要尺寸及重量 Main Dimensions and Weight

公称通径 DN	d	L	H
H64Y-1500Lb			
2 1/2	56	254	282
3	64	305	300
4	84	406	350
5	100	483	425
6	126	559	400
8	158	711	490
10	200	864	540
12	250	991	650
14	280	1067	710
H64Y-2000Lb			
2 1/2	50	330	240
3	60	368	305
4	80	457	315
5	96	533	409
6	118	610	465
8	147	762	528
10	180	914	613
12	222	1041	680
14	254	1118	745
H64Y-2500Lb			
3	54	368	297
4	70	457	385
5	86	533	410
6	104	610	455
8	130	762	557
10	162	914	615
12	210	1041	715
14	234	1118	790
16	264	1245	815
18	304	1397	815